

**ARK626 -
Architectural
Transformation and
Environmental care**

Fall 2021 MPARC Chalmers
School of Architecture

Analytical Workshop
Site and Building Model



Analytical Workshop

The analytical workshop was a two day workshop carried out in groups. The aim was to understand and analyse the site through model making.

Students:

Clara Alexandersson Frick
Ebba Barkfors
Andrea Eklund
Kajsa Engelbrektsson
Michael Gates Carlsson
Victor Hjalmarsson
Lisa Johansson
Michelle Jönsson
Erkka Juusela
Barbara Kraus
Saskia Langbein
Emma Law-Bo-Kang
Yongting Lu
Félix Maisonneuve
Larissa Müller
Ebrahim Rahmani
Jean-Luc Robbins
Kajsa Rosenlund Lindvall
Karin Elisabeth Sahlin
Alida Schultz
Ondrej Zgraja

Teachers:

Elke Miedema
Oscar Carlsson
Tabita Nilsson

Examiner:

Joaquim Tarraso

Building Model





Site Model

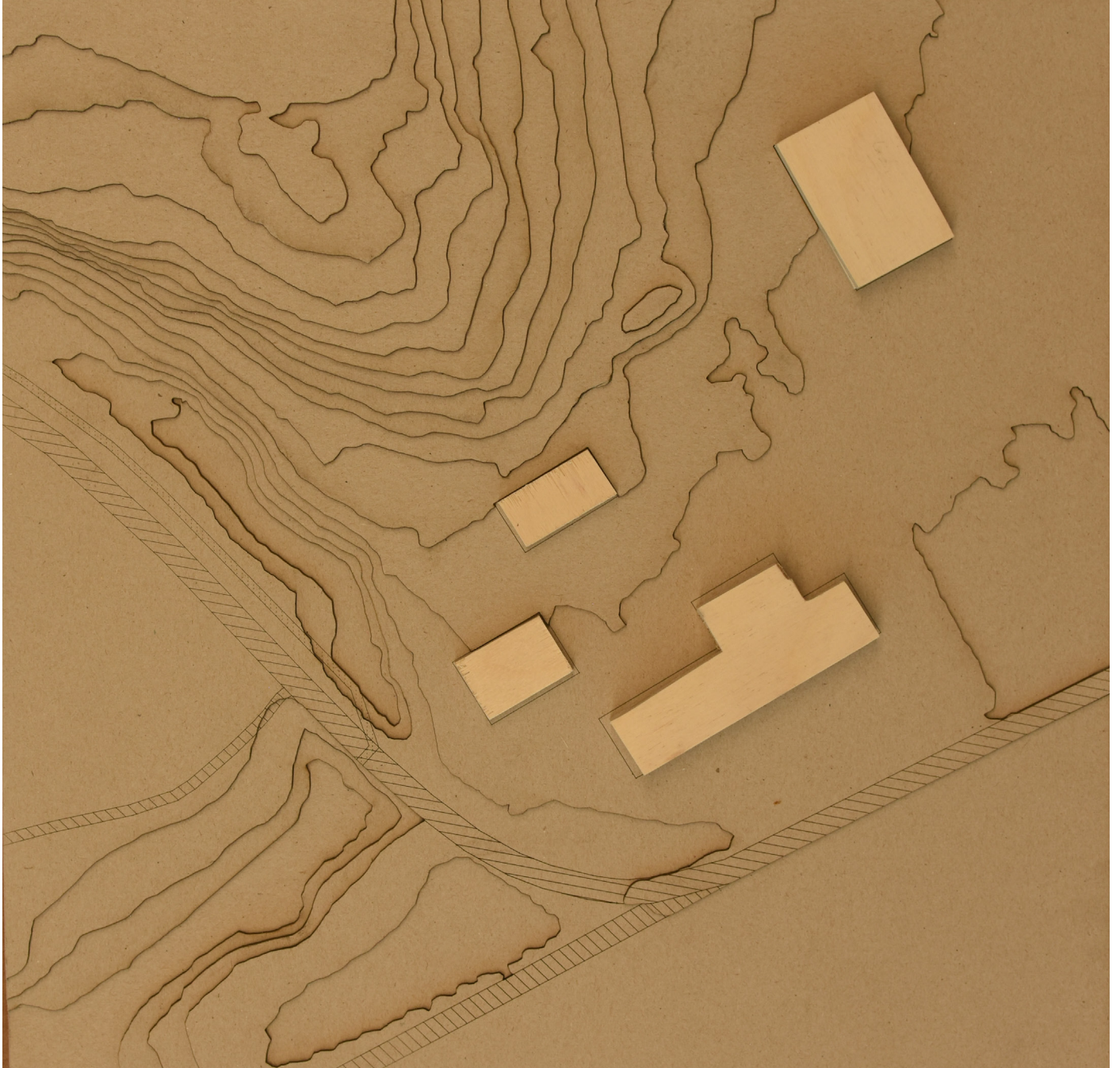

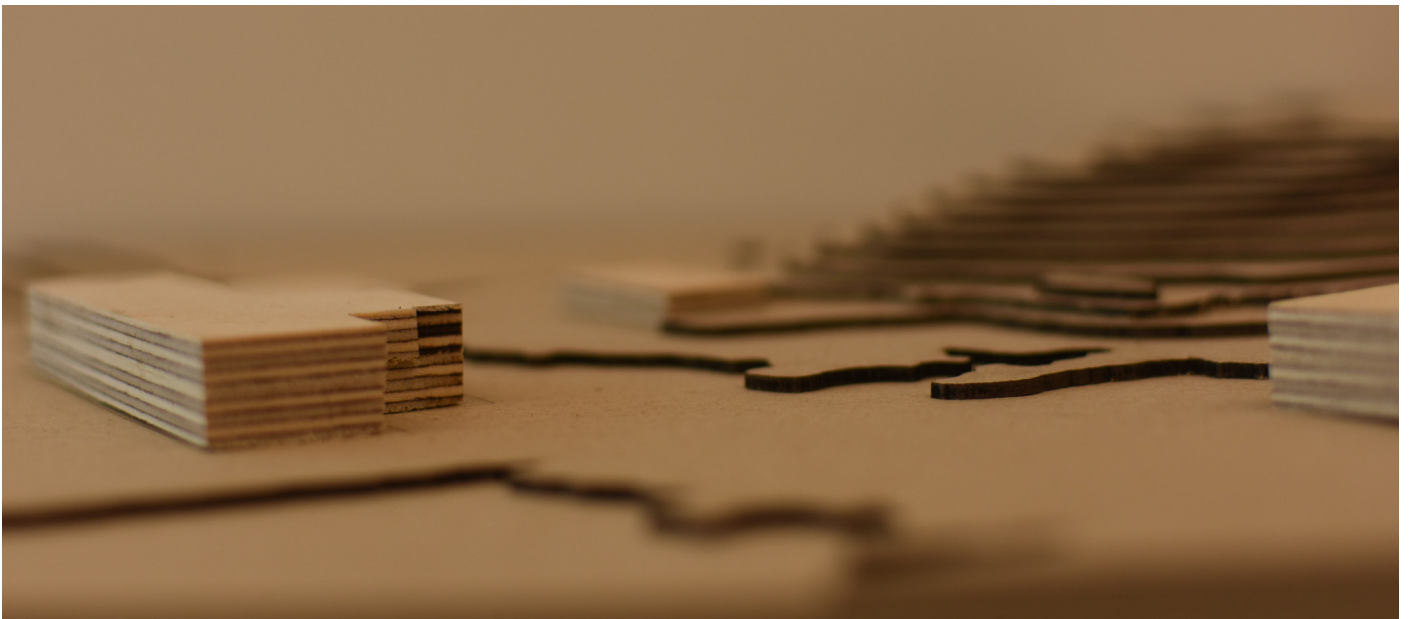
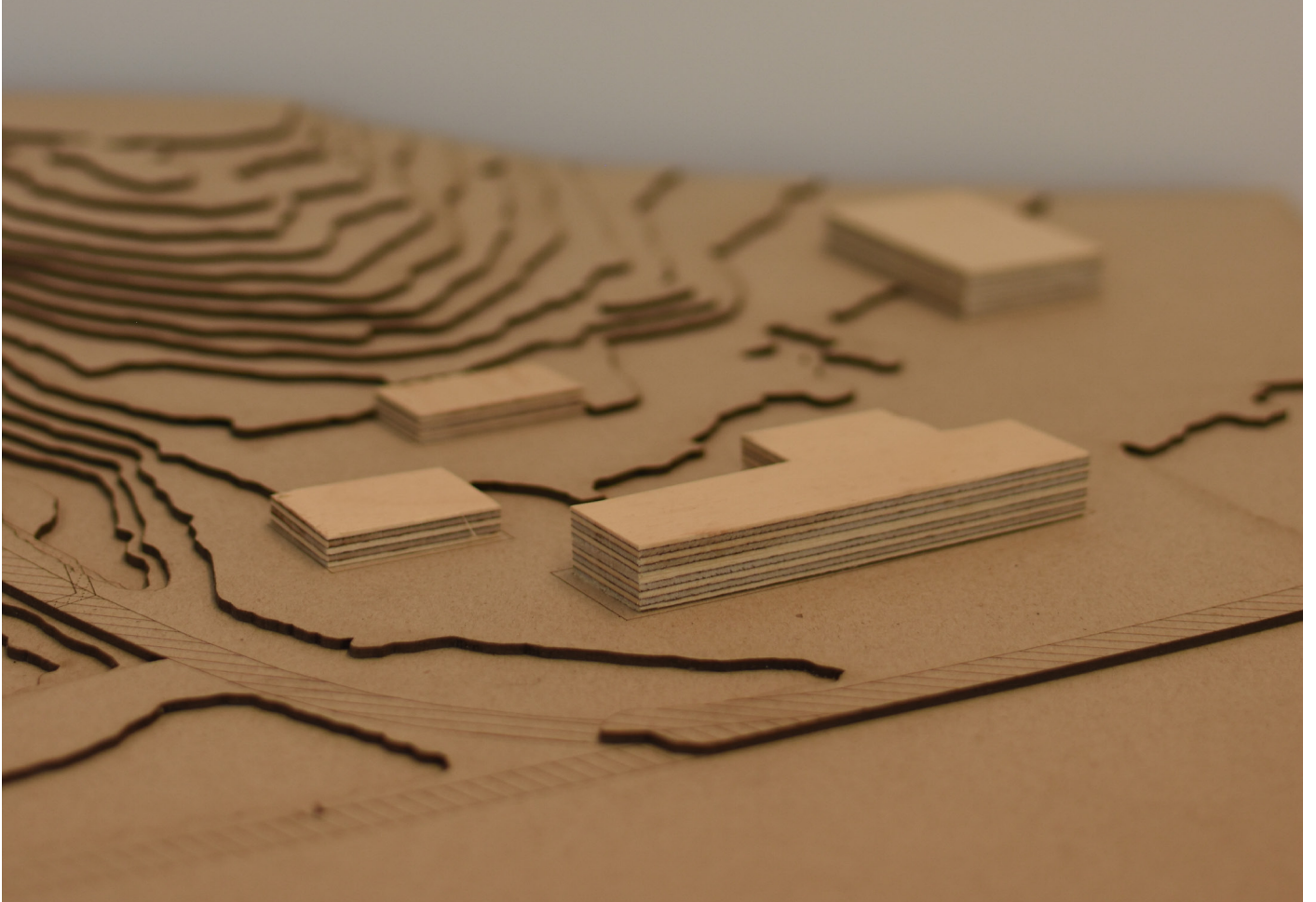

Volume study

This model presents a study of Orust dairy factory in volumes to gain further understanding of the building layout and how they are connected. A preliminary foam model of volumes representing each space was created and later developed into a wooden model.



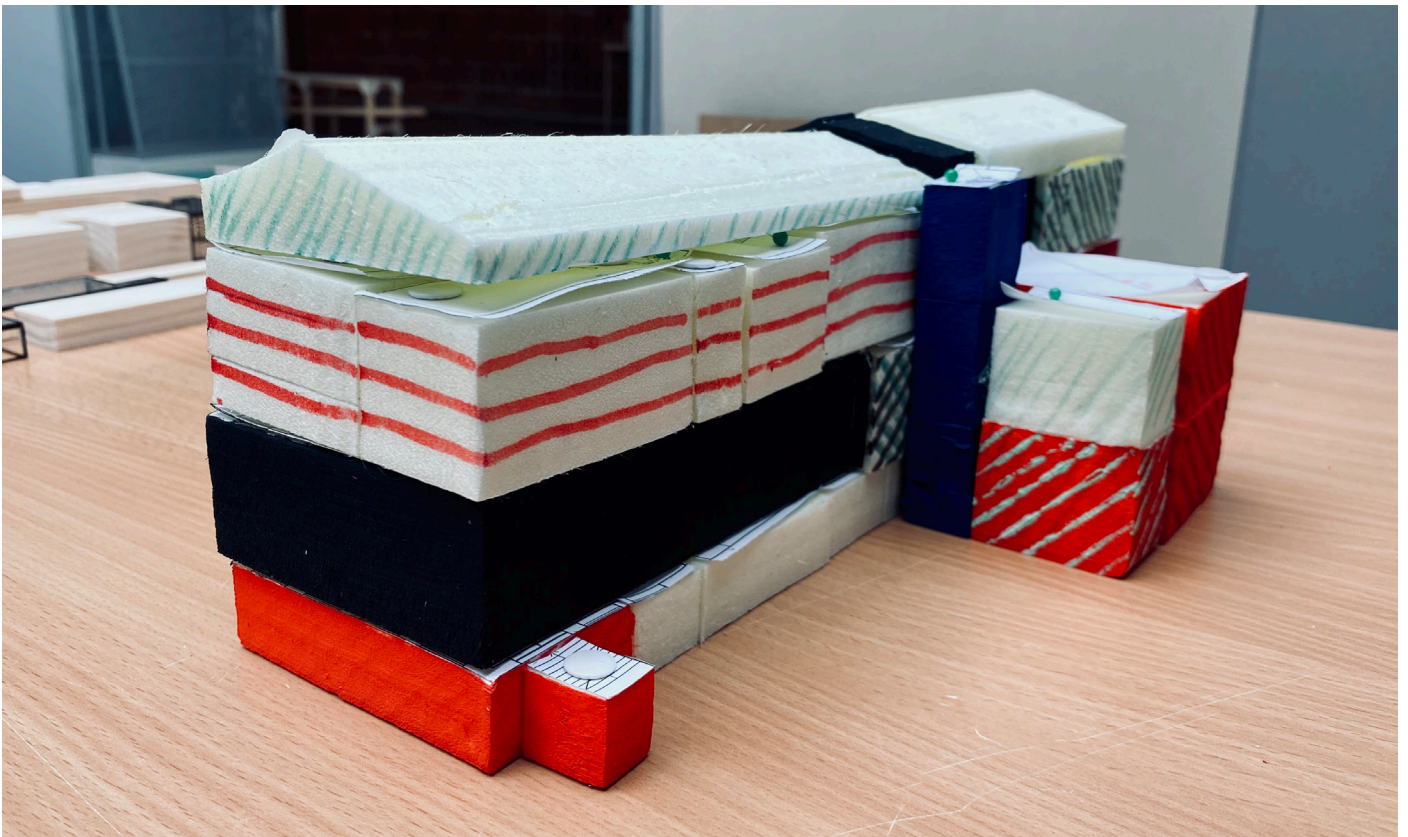

Study of LMC Vräland Mejeri

Through studies of the dairy factory during its prime in the mid 20th century, the model interprets workflow and interior composition in relation to the building's exterior.

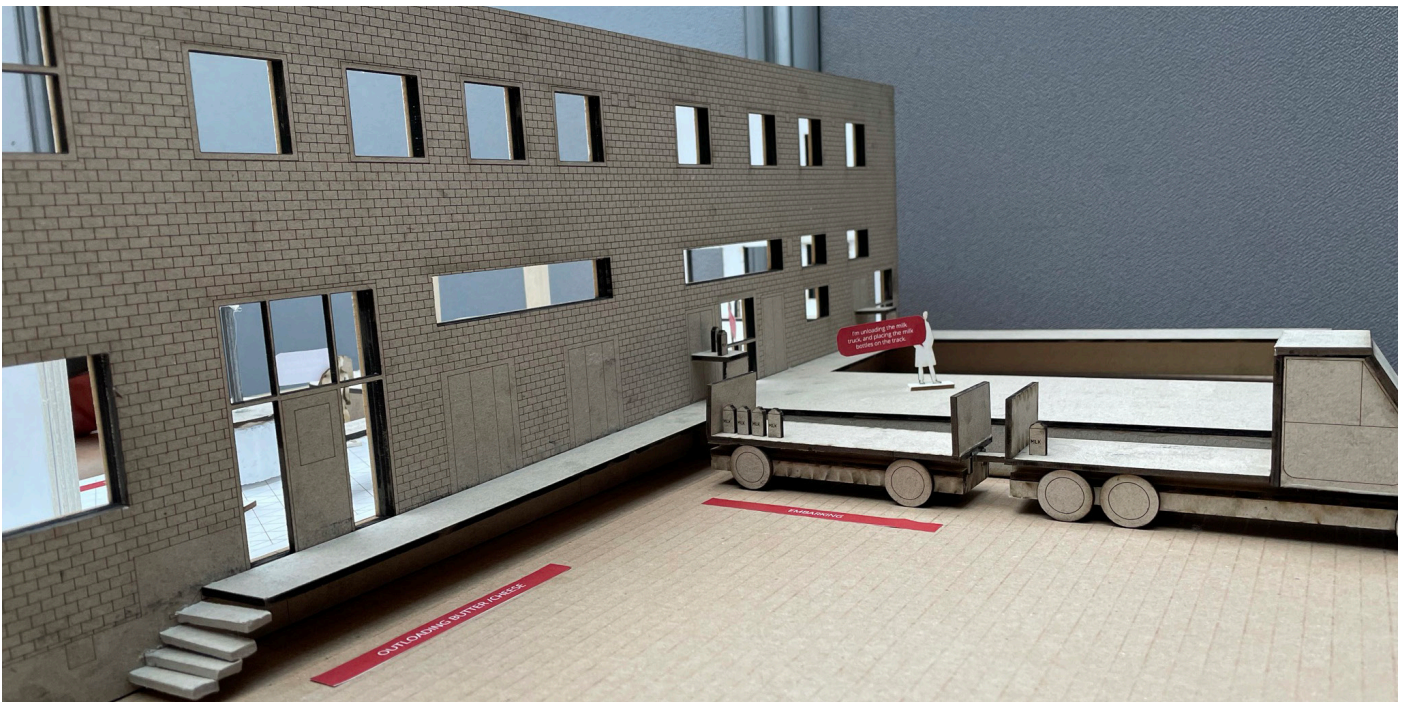

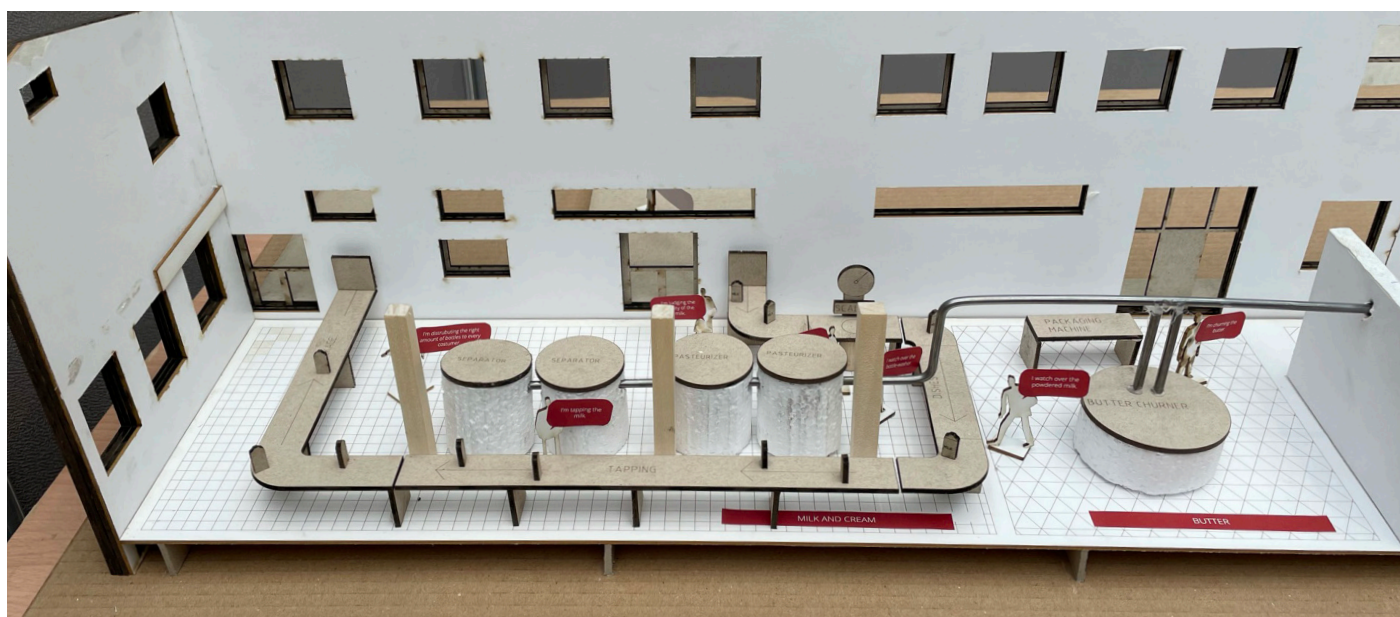

Population - summer / winter

Model of how the relation between all-year inhabitants and tourists looks under the summer months compared to how it looks over the year. In summertime, the average number of people on the Island is 40 000. 15 000 people live on the island all year round.

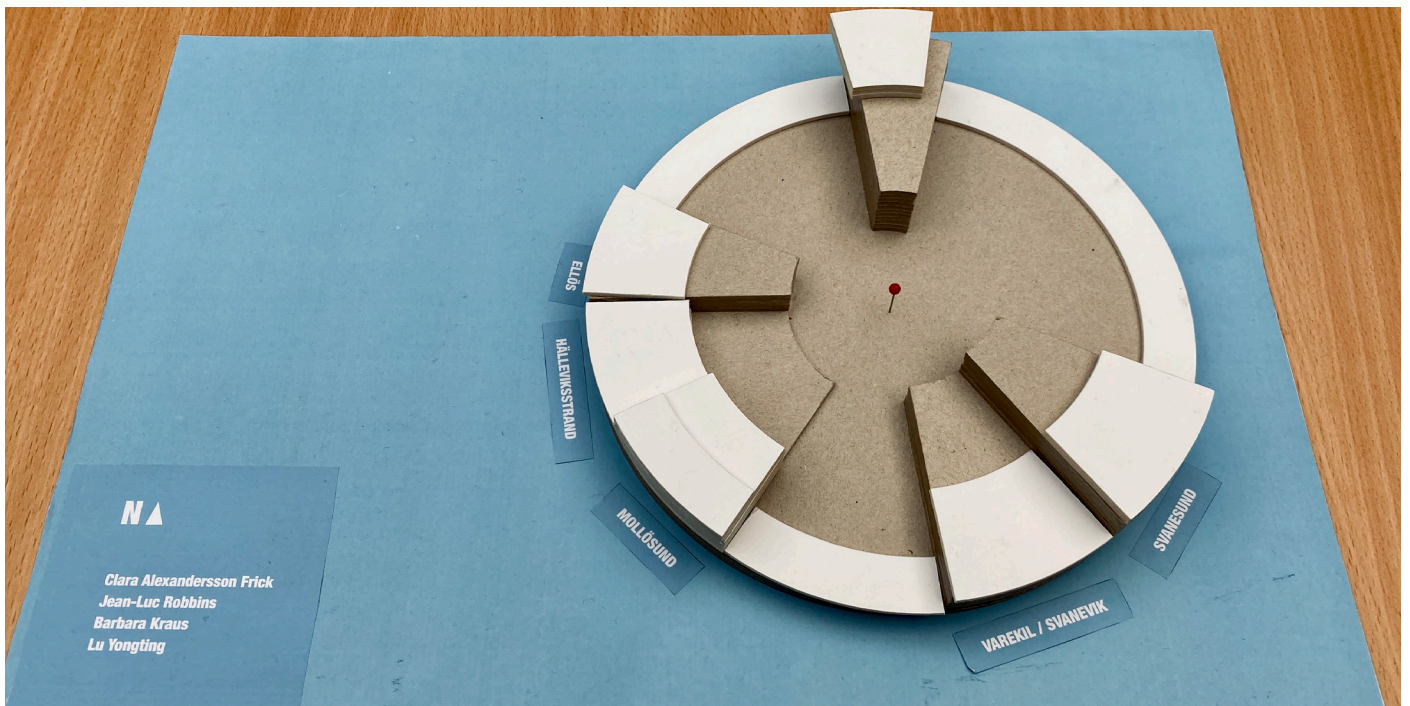
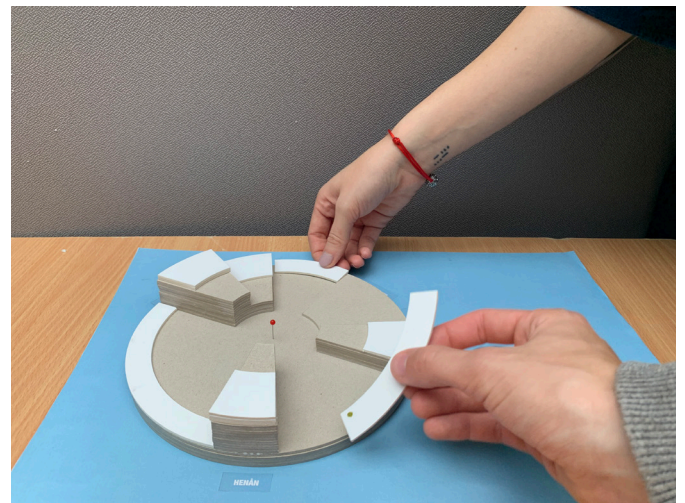
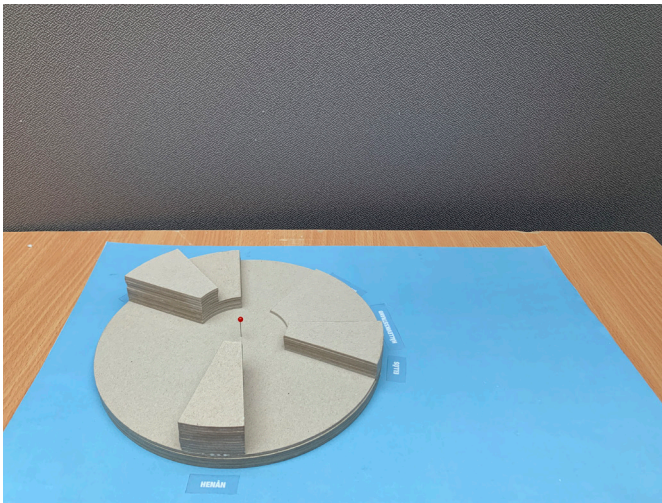

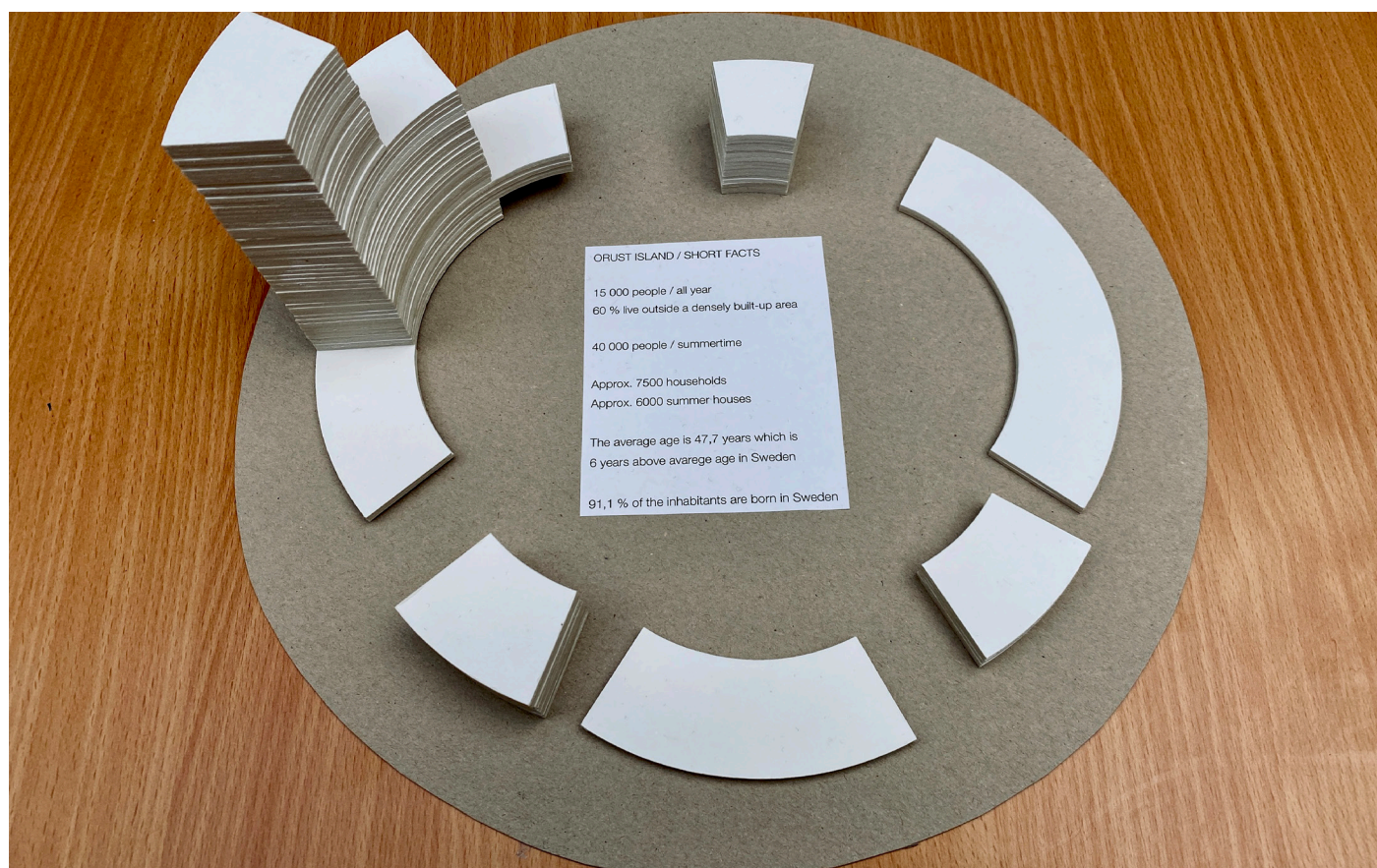
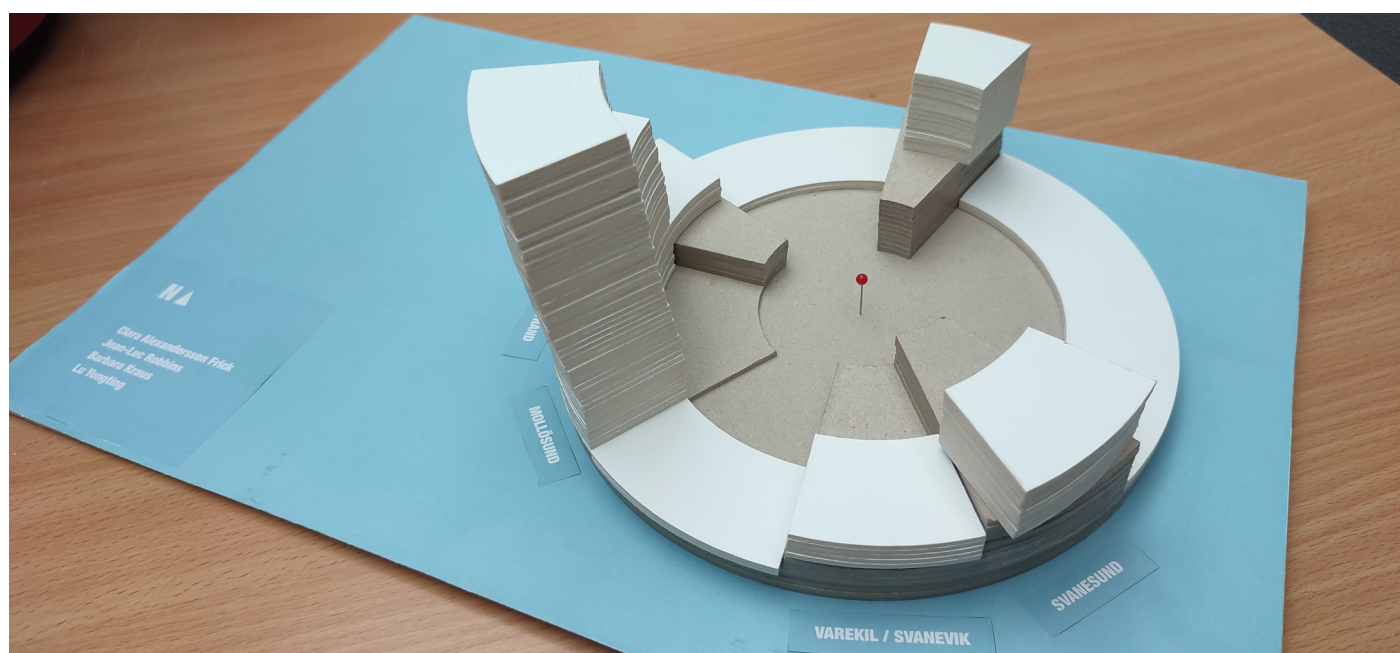

Historical study of the local industries on the island

The model explores the varied industries on Orust island from the 1850 to current day through layered mapping of used areas based on the industries and tries to present a comprehensive understanding of the island's rich industrial history geographically. The model is made out of birch ply and coloured print on plastic film to create a 3d interactive model where the island can be looked through different industries, different time periods or as a whole.

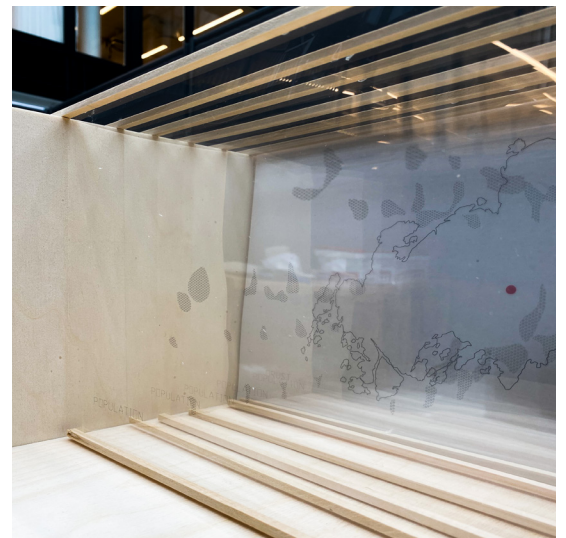
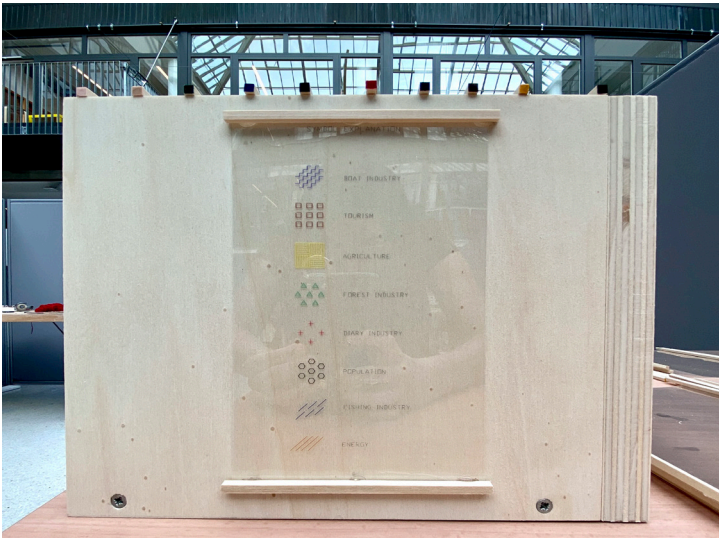

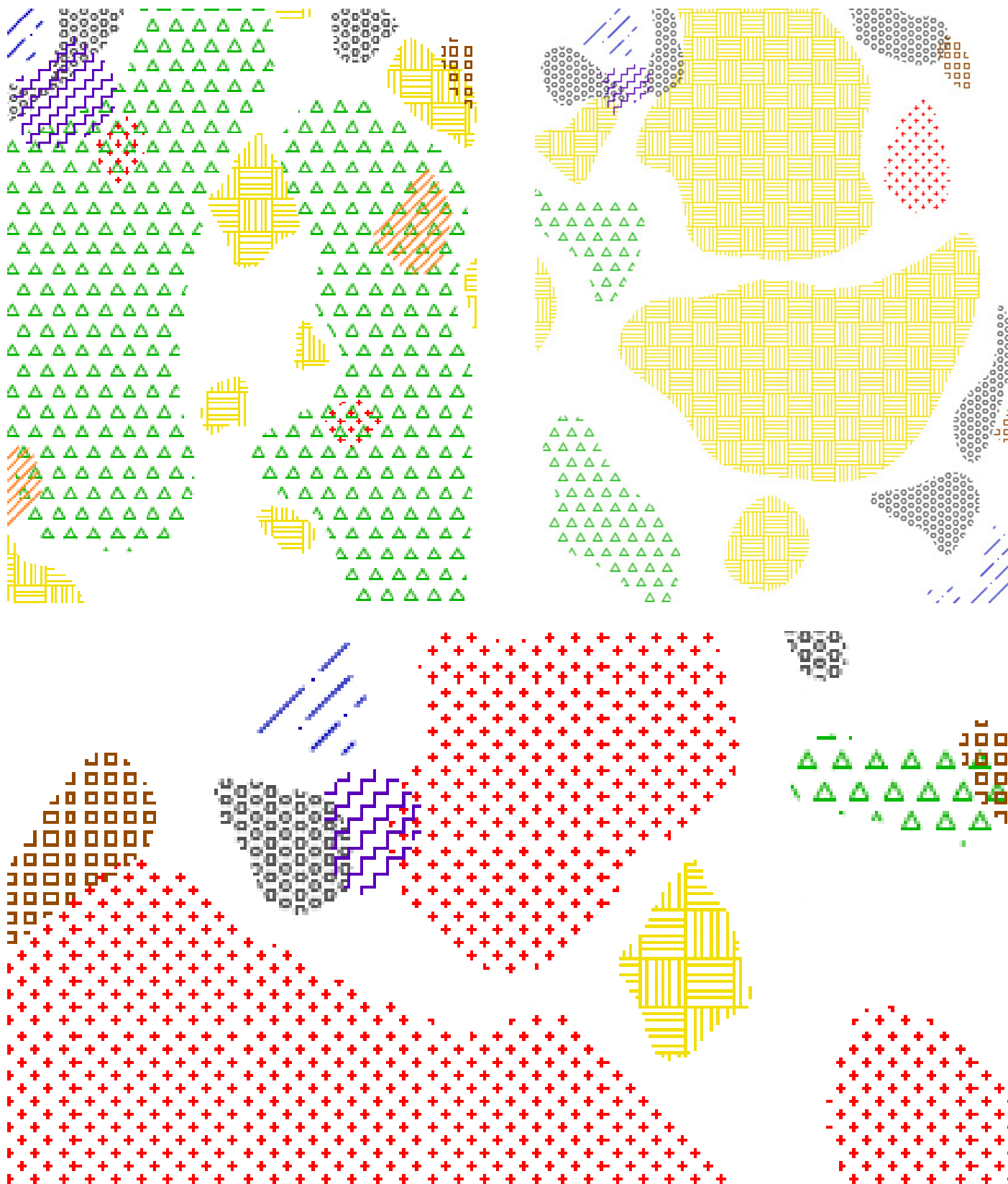

Population, services and connections

The basis of the model represents with its topography the amount of inhabitants in different parts of the island. Here, we can see that all the larger settlements are located on the coastline, especially in the west. The public services mostly follow these population patterns, there are eight preschools, four schools, one gymnasium and two clinics on the island.

The island is connected to the mainland by two bridges and a couple of ferries. The two largest grocery stores are located just the road heading from the bridges. The highest intensity of traffic is between these bridges and the towns by the coastline. An important role plays the north-south road in the middle of the island, passing by the site.



